



Client:



Site Address:

**EMPIRE INDUSTRIAL ESTATE**  
Peachey Road,  
Luscombe

RPD:

Lot: 10  
Plan: SP256167  
Locality: Luscombe  
Local Authority: Gold Coast City Council

Associated Consultants:

©2012 Gassman Development Perspectives  
All rights reserved. No part of this document may be reproduced or transmitted in any form or by any means, electronic, mechanical, photocopying, recording, or otherwise, without the written permission of Gassman Development Perspectives.

This plan has been prepared for the exclusive use of the client as stated on this plan for the purpose of application to the relevant local authority for material change of use and/ or reconfiguration of the land as described and should not be used by any other person or corporation and for any other purpose.

Property Boundaries have not been defined by this survey but compiled from SP194851 and are considered accurate for the purpose of this plan.

All dimensions are approximate only and subject to survey.

This plan may not be photocopied unless these notes are included.

Gassman Development Perspectives Pty. Ltd. accepts no responsibility for any loss or damages caused in contravention of the above.

Issue	Date	Description	DRN	CHK
C	31-03-16	Zoom In, hatch stage 4	SJH	BFG
B		Minor changes	SJH	BFG
A	23-03-16	Adding in Stage 4	SJH	BFG
-	11-03-16	ORIGINAL ISSUE	SJH	BFG

Scale at A3: 1:3000

Date: 31-03-16

Design:

Drawn: SJH

Checked:

Drawing Title:

**PROPOSED STAGED  
RECONFIGURATION  
OF A LOT PLAN  
Stage 2**

Drawing No: 5390 P MP 29C

Rev. No:

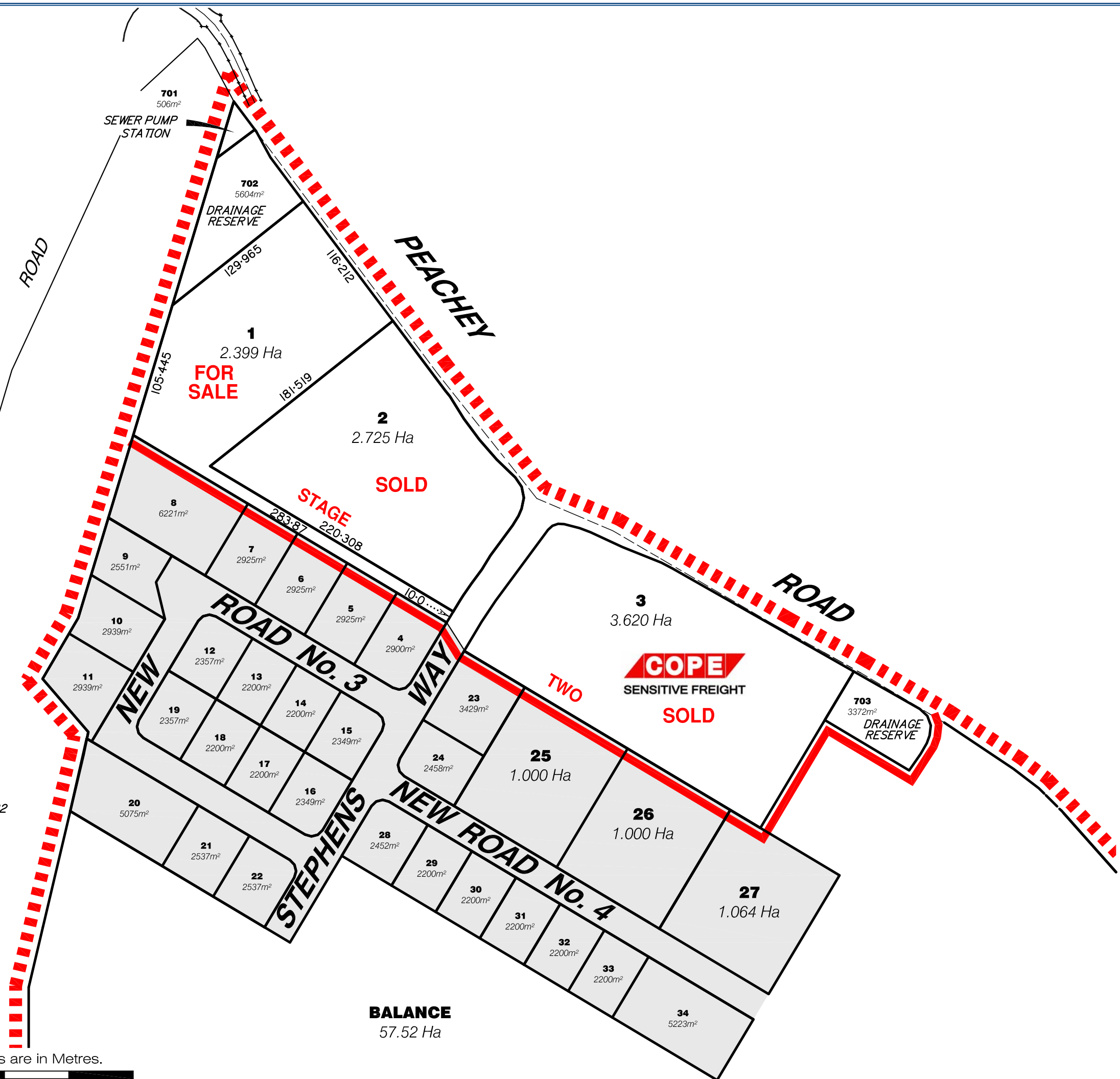

Scale 1:3000 - Lengths are in Metres.

